

# TECHNICAL DATA SHEET

## TED1225EV 12V 25Ah

- Long cycle life: approx. 400–600 cycles 100% DOD. Flame retardant (UL94) HBO.
- Higher energy capacity: +10% compared to standard (patent negative pasting formula).
- Better durability: less than 50% grid corrosion resistance (rare-earth patent alloy).
- Extended performance: 0% acid stratification (nano silica GEL technology).



### PHYSICAL SPECIFICATIONS

Model	Dimensions (mm)			Weight (kg)	Terminal	Design Life
	Length	Width	Height			
TED003782	178	77	171	6.1 kg	M5/I10	20°C (68°F): 5-7 Years

### PRODUCT SPECIFICATIONS

Nominal Voltage	Rated Capacity 25°C/77°F	Operating Temp. Range	Capacity Effected Temp	Capacity vs Storage Time (25°C/77°F)
12V	25Ah 20hr Rate (1.80V/cell)	Discharge: -15°C ~ 50°C	40°C (104°F): 106%	3 months: 90%
	22.0Ah 10hr Rate (1.75V/cell)	Charge: 0°C ~ 40°C	25°C (77°F): 100%	6 months: 80%
	21.5Ah 5hr Rate (1.75V/cell)	Storage: -15°C ~ 40°C	0°C (32°F): 85%	9 months: 60%
	20.0Ah 2hr Rate (1.75V/cell)	Optimum: 25°C ± 2°C	-15°C (5°F): 72%	12 months: 45%
Charging Current		Limited Voltage		Floating Voltage
Limited Current: ≤ 5A (0.2C <sub>2A</sub> )		14.6 ~ 14.8V 25°C (77°F)		13.6 ~ 13.8V 25°C (77°F)
Container Material		Internal Resistance		Maximum Discharge Current
ABS UL94-HBO		~ 10mΩ		250A

### PRODUCT DIMENSIONS

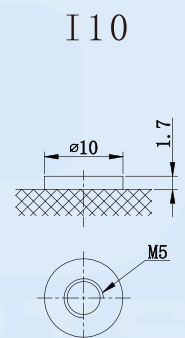
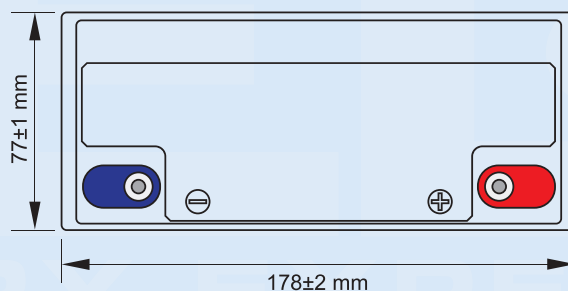
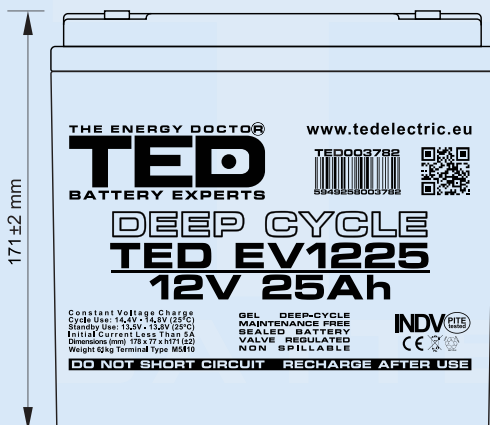

**Constant Current Discharge (A) at 25°C (77°F)**

F.V/Time	30 min	45 min	1h	2h	3h	4h	5h	6h	8h	10h	20h
<b>1.85V/Cell</b>	26.7	19.1	15.1	8.65	6.06	4.68	3.89	3.31	2.58	2.10	1.15
<b>1.80V/Cell</b>	27.6	19.6	15.6	8.94	6.19	4.83	4.04	3.44	2.65	2.16	1.25
<b>1.75V/Cell</b>	28.5	20.4	16.2	10.0	6.73	5.06	4.29	3.61	2.73	2.20	1.21
<b>1.70V/Cell</b>	29.2	20.9	16.7	10.1	6.80	5.18	4.33	3.68	2.79	2.26	1.24
<b>1.67V/Cell</b>	29.8	21.6	17.3	10.2	6.90	5.31	4.46	3.76	2.86	2.30	1.25
<b>1.60V/Cell</b>	30.6	22.2	17.6	10.5	7.14	5.46	4.52	3.85	2.93	2.37	1.26

**Constant Power Discharge (W/cell) at 25°C (77°F)**

F.V/Time	30 min	45 min	1h	2h	3h	4h	5h	6h	8h	10h	20h
<b>1.85V/Cell</b>	52.2	37.6	29.9	17.2	12.1	9.43	7.84	6.69	5.23	4.27	2.34
<b>1.80V/Cell</b>	53.8	38.4	30.7	17.8	12.4	9.69	8.12	6.92	5.35	4.36	2.53
<b>1.75V/Cell</b>	55.1	39.9	31.8	19.8	13.4	10.1	8.59	7.23	5.48	4.43	2.44
<b>1.70V/Cell</b>	56.2	40.6	32.6	19.8	13.5	10.3	8.62	7.33	5.59	4.52	2.49
<b>1.67V/Cell</b>	57.0	41.6	33.6	19.9	13.6	10.5	8.82	7.44	5.66	4.57	2.49
<b>1.60V/Cell</b>	58.0	42.4	33.9	20.4	13.9	10.7	8.86	7.56	5.77	4.68	2.51

**Discharging Characteristics@25°C(77°F)**

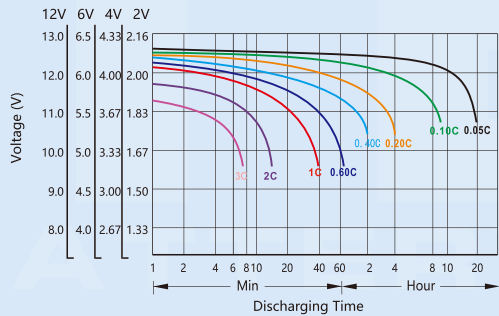

**Charging Characteristics@25°C(77°F)**

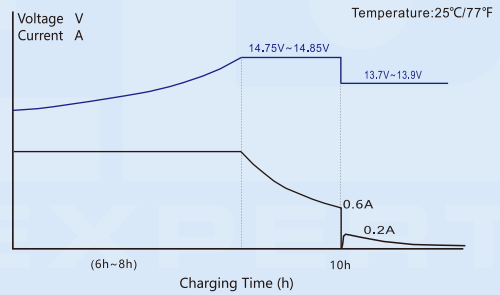

**Capacity vs Temperature**

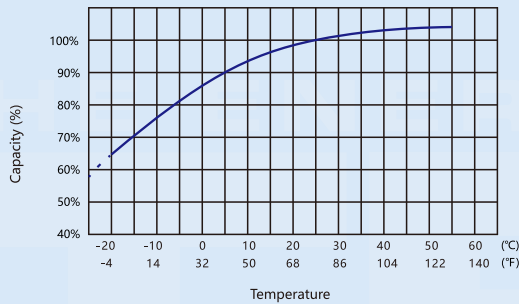

**Self-discharge vs Time**

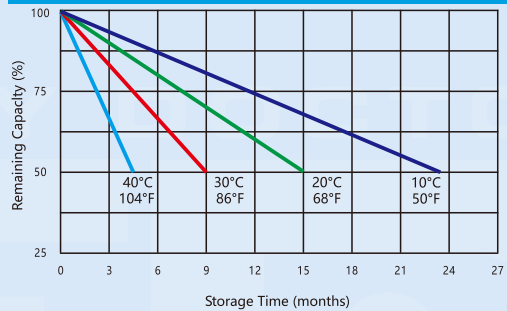

**Cycle Life vs Depth of Discharge@25°C(77°F)**

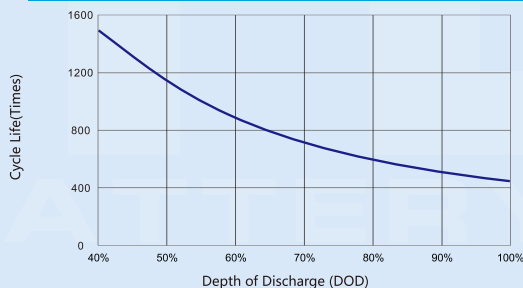

**Cycle Life vs Remaining Capacity@25°C(77°F)**

